



LEGEND

-  Well
-  Town
-  Stock Pond
-  Sub-Area Boundary
-  Section Boundary

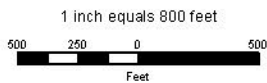
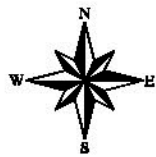

Zuni River Basin
Hydrographic Survey

Sub-Area 8
Subfile Number: ZRB-1-0100
PLSS: S33, T09N, R13W
Sheet 5 of 9

January 2005





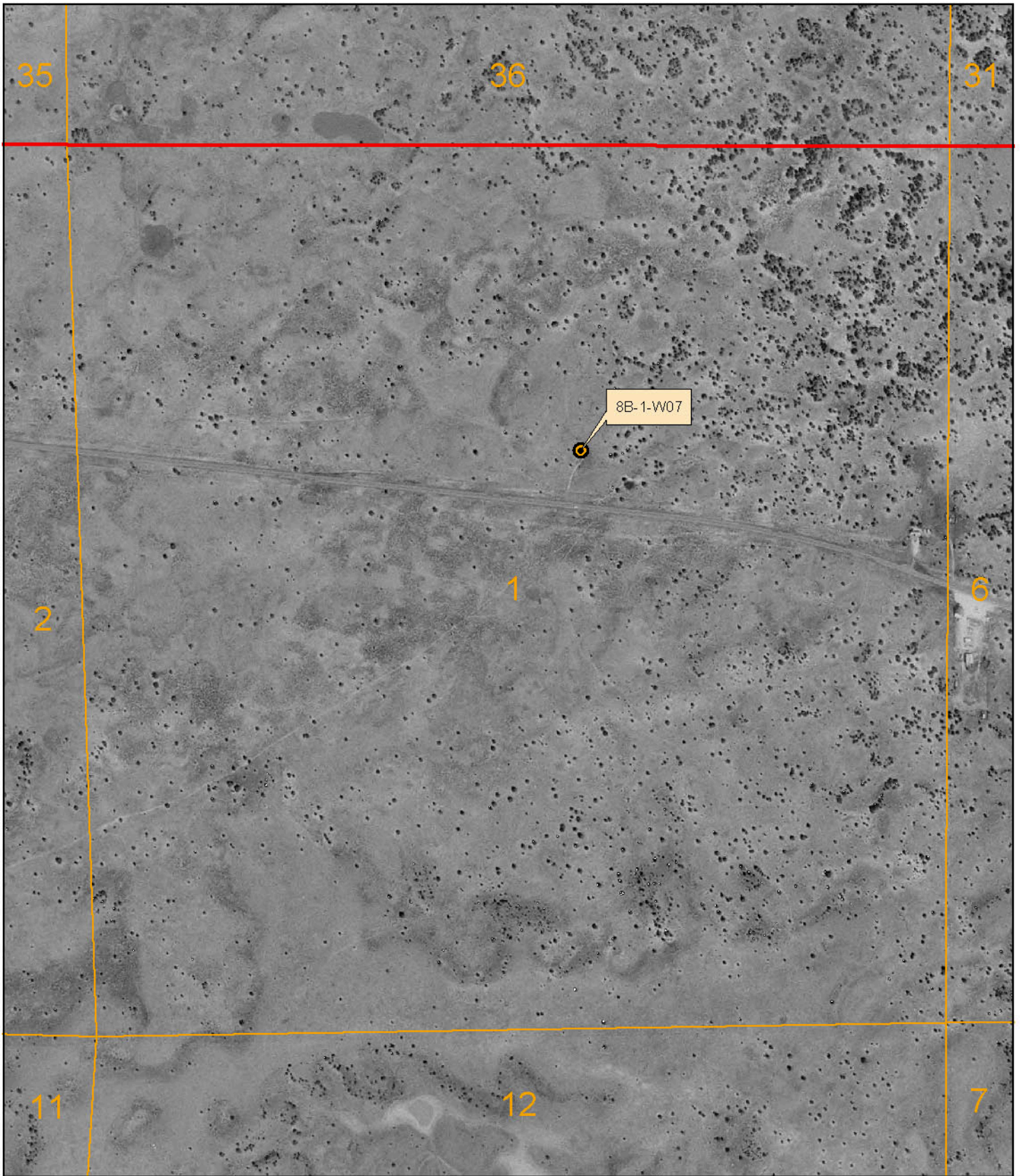

Natural Resources Consulting Engineers, Inc.

Fort Collins, CO Oakland, CA Asmara, ERITREA

Project Manager: L. Niel Allen, P.E., Ph.D.



LEGEND

-  Well
-  Town
-  Stock Pond
-  Sub-Area Boundary
-  Section Boundary

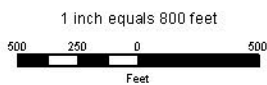

Zuni River Basin
Hydrographic Survey

Sub-Area 8
Subfile Number: ZRB-1-0100
PLSS: S01, T09N, R14W
Sheet 6 of 9

January 2005





Natural Resources Consulting Engineers, Inc.

Fort Collins, CO Oakland, CA Asmara, ERITREA

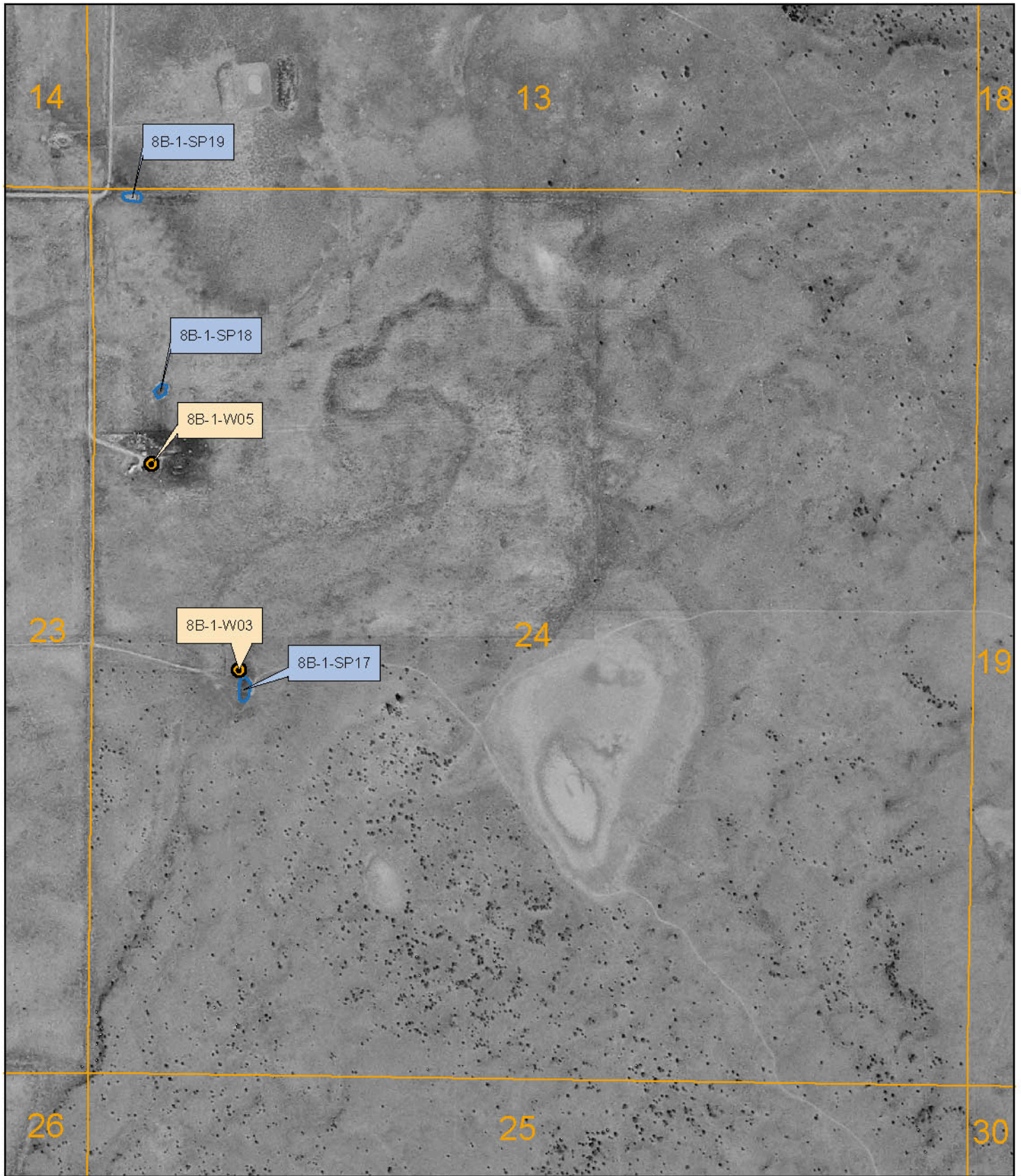
Project Manager: L. Niel Allen, P.E., Ph.D.



LEGEND

-  Well
-  Town
-  Stock Pond
-  Sub-Area Boundary
-  Section Boundary

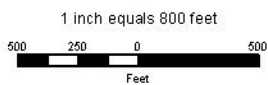

Zuni River Basin
Hydrographic Survey

Sub-Area 8
Subfile Number: ZRB-1-0100
PLSS: S24, T09N, R14W
Sheet 7 of 9

January 2005



Natural Resources Consulting Engineers, Inc.

Fort Collins, CO Oakland, CA Asmara, ERITREA

Project Manager: L. Niel Allen, P.E., Ph.D.



LEGEND

-  Well
-  Town
-  Stock Pond
-  Sub-Area Boundary
-  Section Boundary

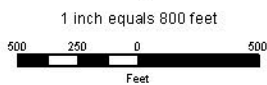
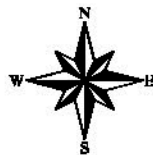

Zuni River Basin
Hydrographic Survey

Sub-Area 8
Subfile Number: ZRB-1-0100
PLSS: S26, T09N, R14W
Sheet 8 of 9

January 2005





Natural Resources Consulting Engineers, Inc.

Fort Collins, CO Oakland, CA Asmara, ERITREA

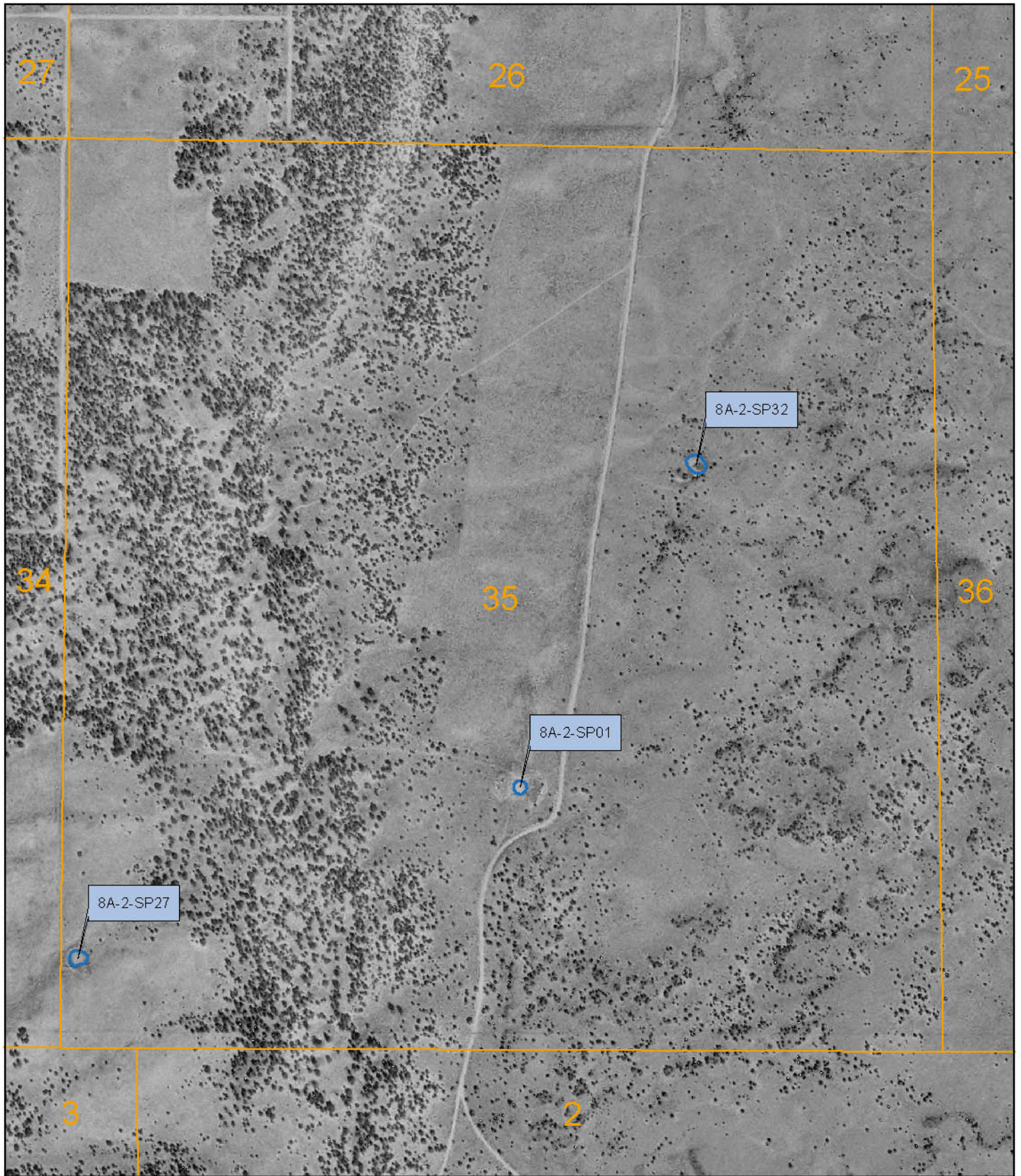
Project Manager: L. Niel Allen, P.E., Ph.D.



LEGEND

-  Well
-  Town
-  Stock Pond
-  Sub-Area Boundary
-  Section Boundary

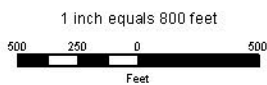

Zuni River Basin
Hydrographic Survey

Sub-Area 8
Subfile Number: ZRB-1-0100
PLSS: S35, T09N, R14W
Sheet 9 of 9

January 2005



Natural Resources Consulting Engineers, Inc.

Fort Collins, CO Oakland, CA Asmara, ERITREA

Project Manager: L. Niel Allen, P.E., Ph.D.